

Lightscan

Mounting instructions

Projector Floodlight Lens wallwasher

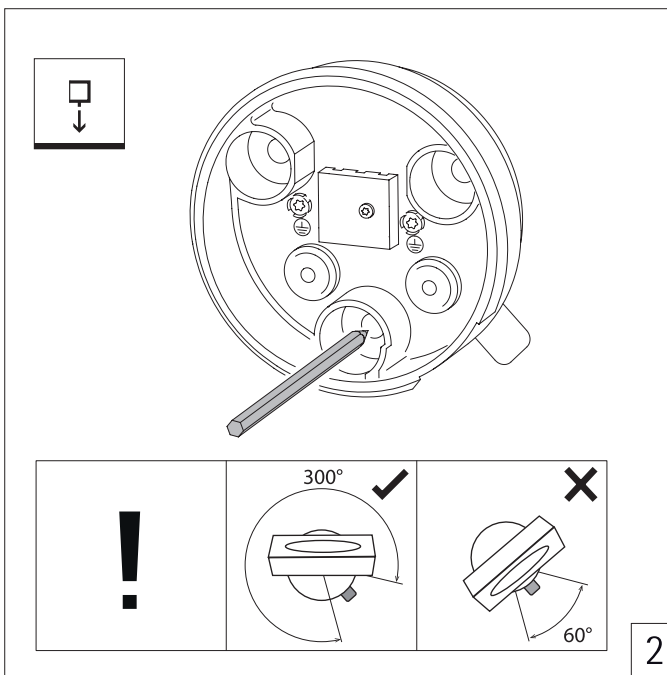
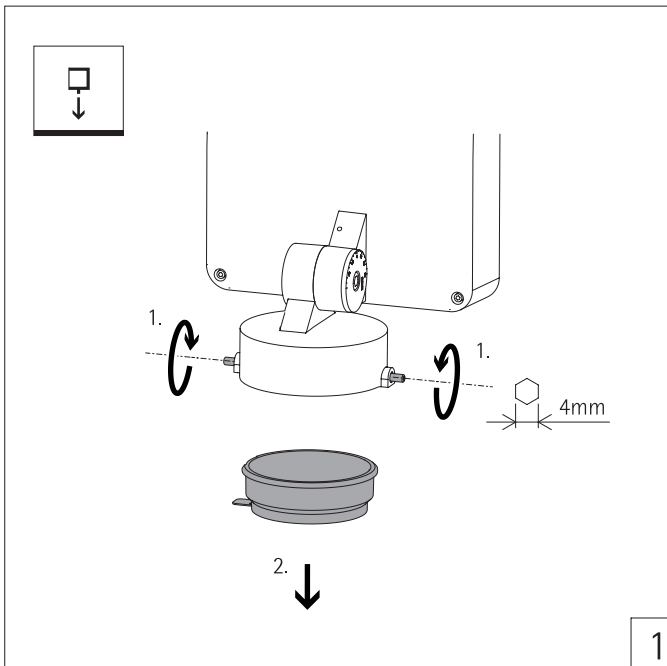

Projector Floodlight Lens wallwasher

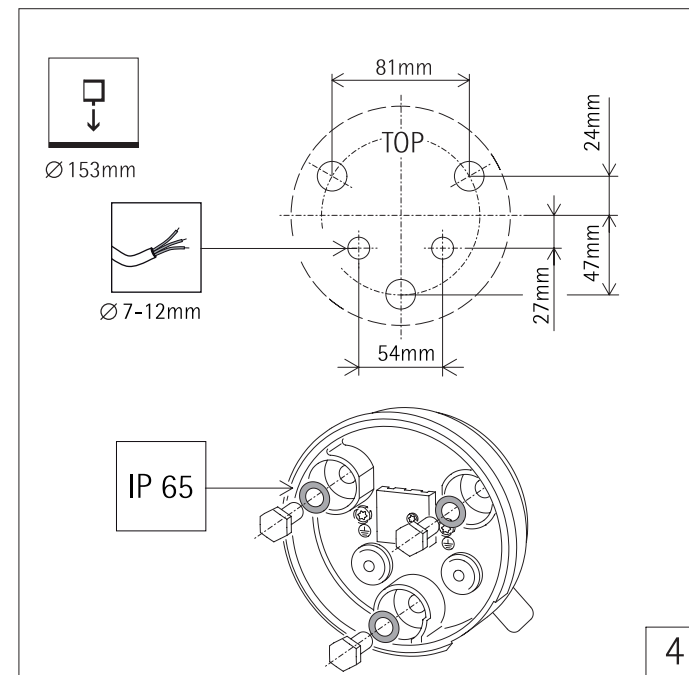
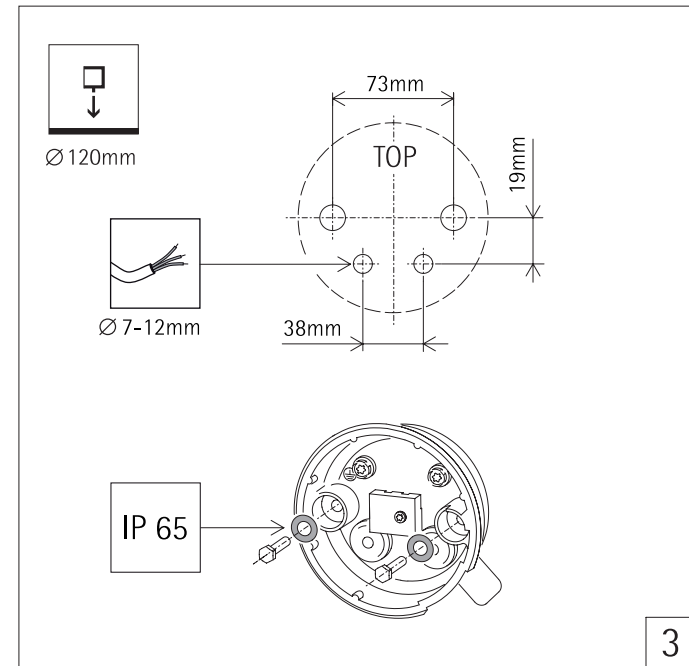

Projector
Floodlight
Lens wallwasher

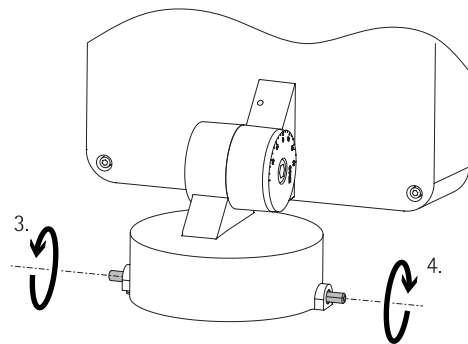
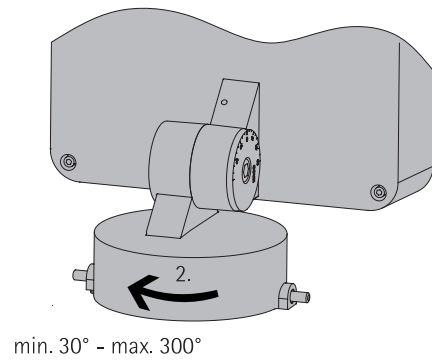
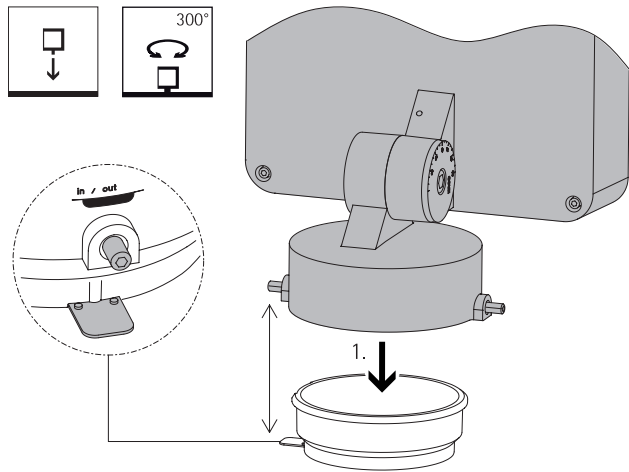

5

Projector
Floodlight
Lens wallwasher

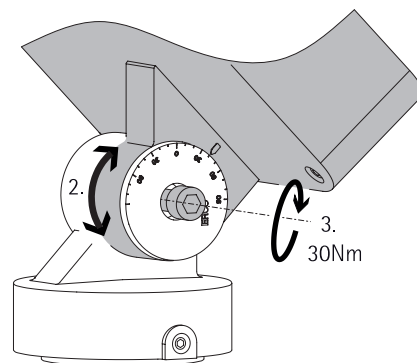
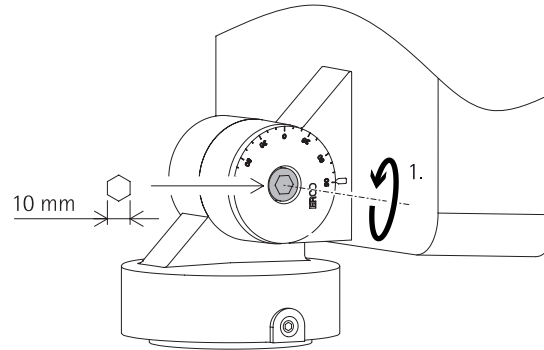

6

Floodlight

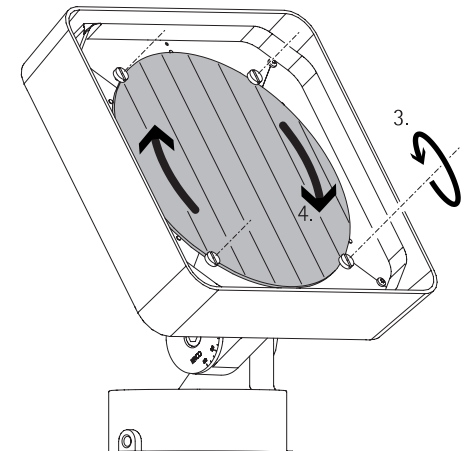
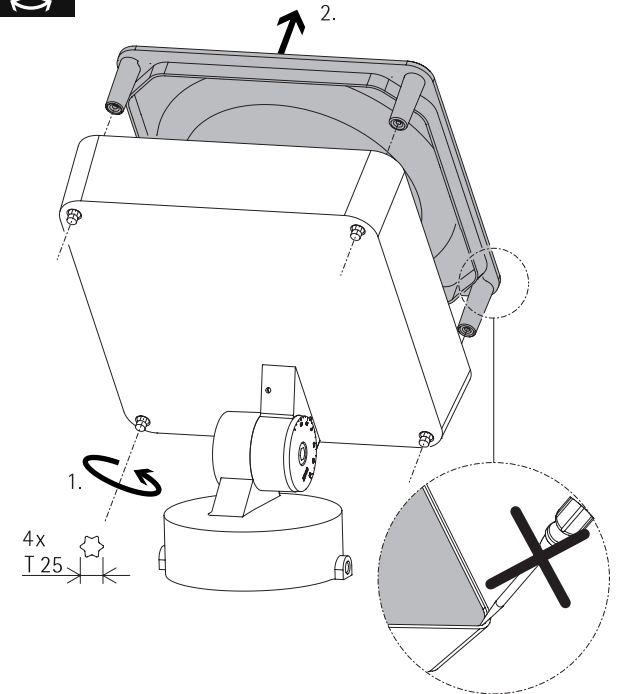

7

Projector Floodlight Lens wallwasher



D (mm)

195x250x299

228x250x313

228x300x363

228x350x413



A (m²)

0.07

0.07

0.10

0.12



W (kg)

5.60

5.60

8.00

9.80

8

English



Read the instructions carefully before installation and commissioning!



Leave the instructions for users/customers for future reference!



Our updated product documentation can be accessed at www.erco.com/download.

General safety information



Warning!
Risk of electric shock!

Before carrying out maintenance and installation on the luminaire, disconnect from the mains supply and also from any other DALI control wiring, and ensure that all power is switched off.



Warning!
Risk of falling parts!

Before working on the luminaire ensure that no one is standing below.

Attention!

- Do not operate luminaires with damaged or missing safety glass.
- In case of damage or a defective LED module, the entire luminaire must be returned to the factory.
- When installing, always observe the national installation and accident prevention regulations.

Intended use

The luminaire is suitable for outdoor and indoor use and is approved for a height of light source exceeding 15m. Dimensions (D), max. reference plane for wind loads (A) and weight (W) are detailed in Fig. 8.

Choosing the mounting location

Position the luminaire so as to avoid operation in direct sunlight or near other sources of heat. High ambient temperatures can reduce the life and efficiency of the control gear or LED module.

Electrical installation

For 3-circuit installation: to avoid any damage to the control gear, the neutral conductor must never be connected or disconnected during operation.

Overvoltage protection

ERCO uses electronic control gear with overvoltage protection in accordance with DIN EN 61547. If additional protection from spikes is required, e.g. when switching off inductive loads, separate overvoltage protection units should be installed.

Luminaire with DALI control gear

- All cables, materials and devices used must be suitable for mains voltage, as the DALI signal is not transmitted using safety extra low voltage (SELV).
- For general information on DALI, please go to: www.dali-ag.org.

Varychrome RGBW

For control via a DALI system with colour management, the signal input has a DALI interface with one address for the luminaire. When operated with a system without colour management, 3 addresses are used for each luminaire. The colour compensation guarantees that exactly the same colour of light is obtained from all controlled luminaires which have the same DALI control settings.

Notes on corrosion protection

Ensure that the powder coating is not damaged during installation or maintenance work. Any damage, which becomes wet, can result in corrosion occurring. In aggressive environments, the installation and maintenance of all parts will require the appropriate protective measures. Chemicals damage the corrosion protection.

Installation

Note: The arrow on the base plate indicates the beam direction.

Mounting the base plate onto a concrete plinth (Figures 1-4)

Use the washers supplied.

Caution! Always comply with the standards and regulations in place for the mounting location when selecting the mounting parts. Ensure suitable corrosion resistance as required for the environment.

Note: The luminaire can be mounted using heavy load rawl bolts M6 (Ø 120mm) or M10 (Ø 153mm) in accordance with the manufacturer's instructions.

Mounting the base plate on accessories (Fig. 1)

Base plate Ø 120mm: The luminaire may be mounted on the concrete anchor 33979 or the mounting plate 33982. Base plate Ø 153mm: The luminaire may be mounted on the ground socket 33974, the concrete anchor 33981 or the mounting plate 33982.

Use the washers and cylinder head screws supplied (included with the mounting accessory).

Note: Follow the accessory instructions.

Mounting on upright supporting pole (Fig. 1)

The luminaire may be mounted on an upright supporting pole of Ø 60-89mm using the traverse 34955, the attachment 34953 and die clamping plate 34954.

Note: Follow the accessory instructions.

Mounting the luminaire (Fig. 5)

Connect the earth conductor to the base plate.

Rotate luminaire into the required position and tighten set screws to the specified torque.

Rotating the luminaire (Fig. 5)

Rotate luminaire into the required position and tighten set screws to the specified torque.

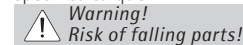

Warning!
Risk of falling parts!

If the set screws are unscrewed too far and the in/out marking on the base plate lines up with the tongue, the luminaire will detach from the base plate. The luminaire may fall off and injure someone below.

Tilting the luminaire (Fig. 6)

Attention! Tighten the screws to the specified torque to prevent water penetrating the luminaire.

Rotating the beam (Fig. 7)

The beam may only be rotated when using floodlights with oval flood characteristic.



Warning!
Risk of falling parts!

Always hold on to the safety glass.

When opening the luminaire, the safety glass may fall off and injure someone below.

Attention! Do not use a screwdriver or similar implements to lift out the glass, as this may damage the glass, the sealing or the housing cover.

Flashing of the LED module

It is normal for the LED module to flicker when switching on and off.

Cleaning

Always clean carefully using a soft cloth and a commercially available, ph-neutral, alcohol-free, non-abrasive cleaning agent.

Take care not to damage the powder-coating.

Cleaning the safety glass

Safety glass can be cleaned with cleaning agents that are also suitable for glass-ceramic cooking hobs.

Disposal

In accordance with EU Directive WEEE (Waste Electrical and Electronic Equipment), luminaires must not be disposed of with other household waste. At the end of their life, luminaires must be taken to the appropriate local facility available for the disposal or recycling of electronic products.