

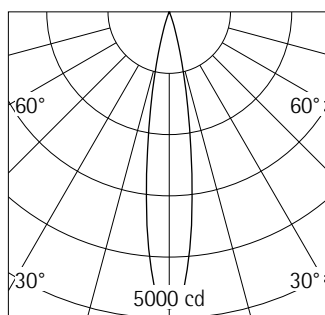

58399.000 White (RAL9002)
LED 6W 630lm 3000K warm white
Casambi Bluetooth
Version 5
Spherolit lens, spot

Product description

Cylindrical light head: cast aluminium, powder-coated. 270° tilt.
Housing: polymer, rotatable on 3-circuit adapter through 360°.
ERCO Casambi control gear.
3-phase adapter for ERCO 220-240V track: polymer, white.
LED module: high-power LEDs on metal-core PCB. Collimating lens made of optical polymer.
Control via Casambi app (Android/iOS) with Bluetooth Low Energy (BLE)-capable mobile devices or "Casambi Ready" products.
Protection Class II
Weight 0.53kg

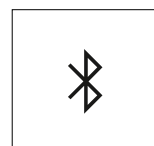
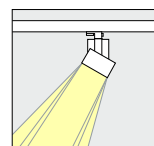
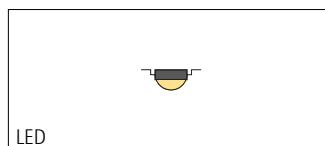
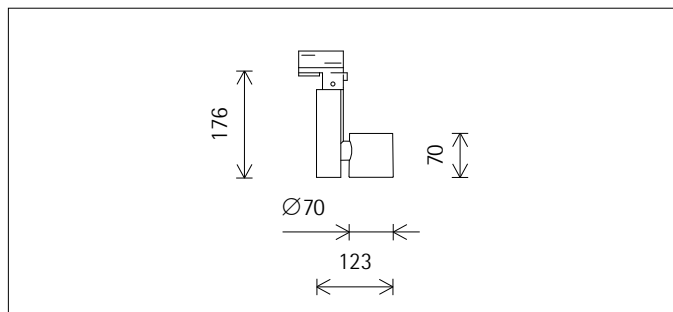

h(m)	E(lx)	D(m)
		17°
1	4848	0.30
2	1212	0.60
3	539	0.90
4	303	1.20
5	194	1.49

Technical data

Luminous flux of the luminaire	551lm
Connected load	8.6W
Luminaire efficacy	64lm/W
Colour deviation	1.5 SDCM
Colour rendition index	CRI 92
Lumen maintenance (LED manufacturer specifications)	L90/B10 ≤50000h L90 ≤100000h
LED failure rate	0.1% ≤50000h
Dimming range	0.1%-100%
Dimming method	CCR
LMF	E
Energy efficiency class	EEI A+
Standby power per control gear	0.4W
Luminaires per circuit breaker B16	260



DALI controllable via accessory
DALI Casambi Gateway for controlling Casambi Bluetooth via DALI.



Mounting

ERCO 3-circuit track
Hi-trac 3-circuit track
1-circuit singlet

For your regional contact in the ERCO
Sales network click here
www.erco.com/contact

Technical Region: 220-240V 50/60Hz
We reserve the right to make technical
and design changes.
Edition: 19.10.2020
Current version under
www.erco.com/58399.000

Planning data

Cleaning (a)	1				2				3			
Ambient conditions	P	C	N	D	P	C	N	D	P	C	N	D
LMF	0.96	0.94	0.90	0.86	0.93	0.91	0.86	0.81	0.92	0.90	0.84	0.79
RSMF	0.99	0.97	0.95	0.92	0.98	0.97	0.95	0.92	0.98	0.97	0.95	0.92

Hours of operation (h)	1000	5000	10000	20000	30000	40000	50000
LLMF	1.00	0.99	0.98	0.96	0.94	0.92	0.90
LSF	1	1	1	1	1	1	1

MF	LMFxRSMFxLLMFxLSF
MF	Maintenance Factor
LMF	Luminaire Maintenance Factor
RSMF	Room Surface Maintenance Factor
LLMF	Lamp Lumens Maintenance Factor
LSF	Lamp Survival Factor
P	Room pure
C	Room clean
N	Room normal
D	Room dirty

Technical data in accordance with international norms and standards

IEC 60598	Luminaires – Part 1+2: general requirements, specific requirements and tests
IEC 62031	LED modules for general lighting – safety requirements
IEC 62471	Photobiological safety of lamps and lamp systems
EN 13032-4	Light and lighting – measurement and representation of photometric data
CIE 13	Method of measuring and specifying colour rendering properties of light sources

All technical data is subject to industrially standard tolerances.
Also see www.ercos.com/ercos-led

Accessories



70851.000
Spherolit lens spot
made of optical polymer.
Replacement without tools.



70852.000
Spherolit lens flood
made of optical polymer.
Replacement without tools.



70853.000
Spherolit lens wide flood
made of optical polymer.
Replacement without tools.



70978.000
Spherolit lens extra wide flood
made of optical polymer.
Replacement without tools.

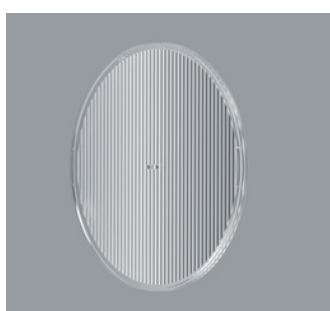

70854.000
Spherolit lens oval flood
made of optical polymer.
Replacement without tools.



70855.000
Spherolit lens wallwash
made of optical polymer.
Replacement without tools.



74389.000
Snoot
Polymer.
White



74396.000
Snoot
Polymer.
Black

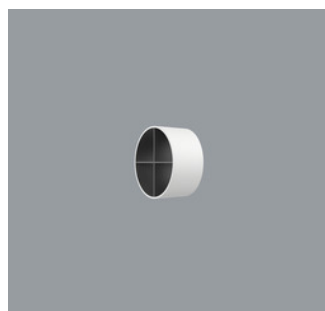

78035.000
Cross-baffle
Aluminium, coated black, polymer
outer.
White

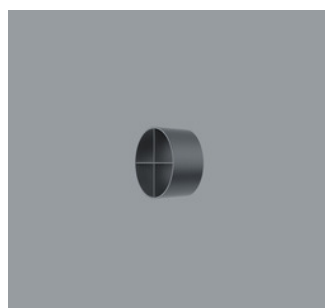

78039.000
Cross-baffle
Aluminium, coated black, polymer
outer.
Black

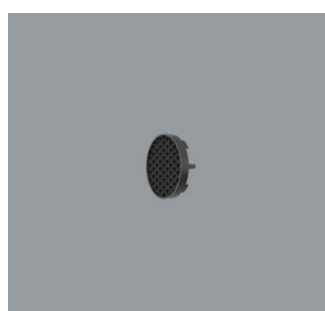

79853.000
Honeycomb anti-glare screen
Black

Accessories



55248.000

ERCO Casambi motion detector with light sensor for ERCO 220-240V track. Setup via Casambi app (Android/iOS) with Bluetooth Low Energy (BLE)-capable mobile devices. Use for daylight-dependent light control with or without motion detector. Detection range of infrared (PIR) sensor 100°/ 5m. At 3m room height, this is a circle with diameter of approx. 7m. 3-phase adapter for ERCO 220-240V track: plastic, white. Available from 3rd quarter 2020
White
Weight 0.18kg
CE 



55249.000

ERCO Casambi motion detector with light sensor for ERCO 220-240V track. Setup via Casambi app (Android/iOS) with Bluetooth Low Energy (BLE)-capable mobile devices. Use for daylight-dependent light control with or without motion detector. Detection range of infrared (PIR) sensor 100°/ 5m. At 3m room height, this is a circle with diameter of approx. 7m. 3-phase adapter for ERCO 220-240V track: polymer, black. Available from 3rd quarter 2020
Black
Weight 0.18kg
CE 

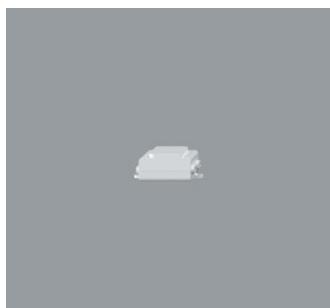

55251.000

DALI Casambi Gateway
Enables DALI systems to be connected to luminaires, sensors and control units with Casambi Bluetooth. The gateway can only be operated in Evolution networks. Power is supplied exclusively via the DALI bus. Connection via two lines which must be designed for mains voltage. The gateway requires no DALI addresses, the devices appear as non-configured devices in the DALI system. Addressing/commissioning is performed via the DALI control. It can individually control 64 devices, and via the broadcast command up to 249 devices.