

Site Grazing light wallwasher

Mounting instructions

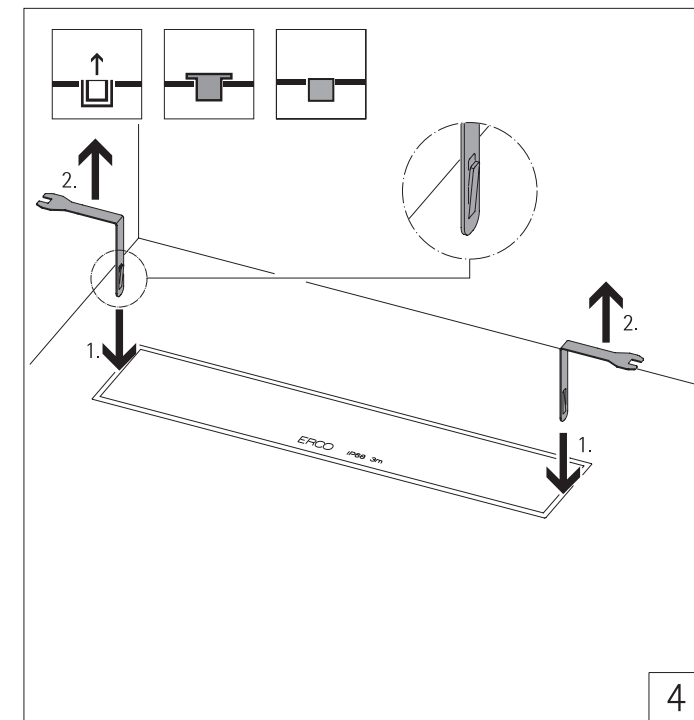

English

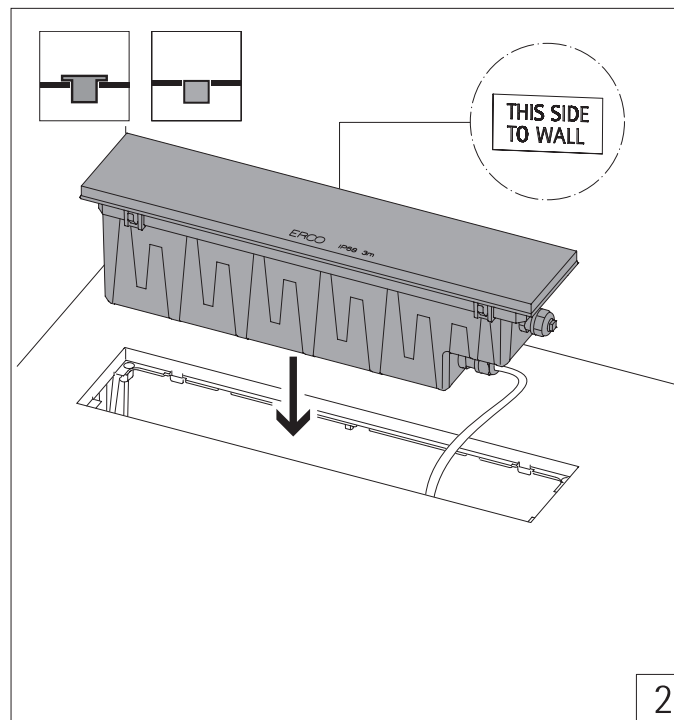
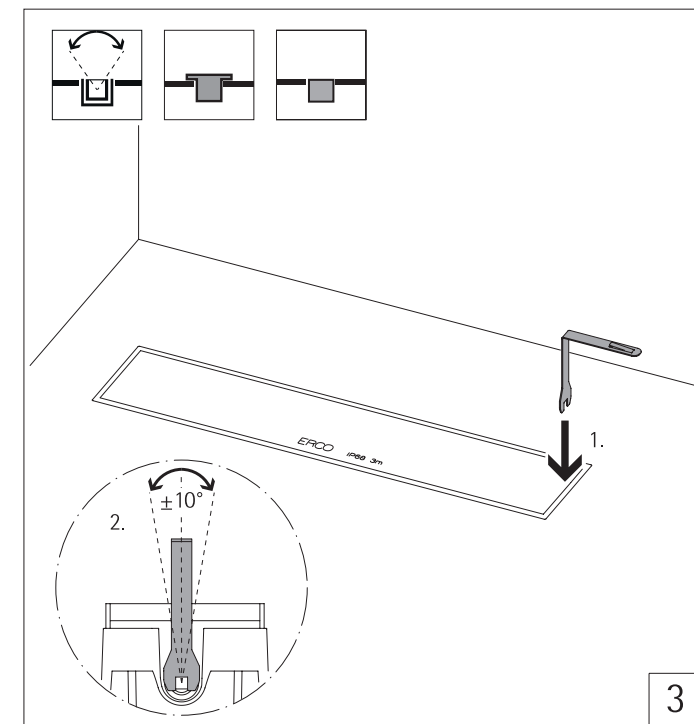
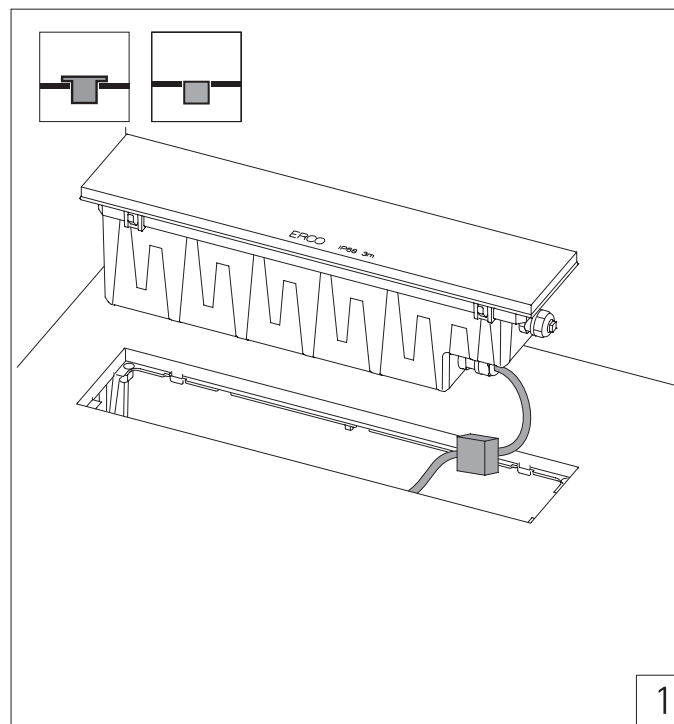

Read the instructions carefully before installation and commissioning!



Leave the instructions for users/customers for future reference!



Our updated product documentation can be accessed at www.erco.com/download.

Required mounting accessories

Mount only in recessed housing 33293 or use mounting kit 33293.

Recessed housing

for mounting luminaires flush or to cover the edge.

Mounting kit

for mounting luminaires in hollow floors to cover the edge.

General safety information



Warning! Risk of electric shock!

- Before carrying out maintenance and installation on the luminaire, disconnect from the mains supply and also from any other DALI control wiring, and ensure that all power is switched off.
- Never operate luminaires with damaged connection cables or damaged or missing protective shield.

Attention!

- Do not open the luminaire. In case of damage or a defective LED module, the entire luminaire must be returned to the factory.
- When installing, always observe the national installation and accident prevention regulations.

Intended use

- The luminaire is dust- and pressure-water tight. It is protected against the consequences of continuous submersion up to a maximum depth of 3m (IP68 3m).
- The luminaire is suitable for both outdoor and indoor use.
- When mounting in hollow or raised-floor structures, please note that only luminaires with overlap trim can be used.
- Luminaires mounted in recessed housing can be walked on. The recessed housing can be driven over by vehicles with pneumatic tyres provided it is screwed to a suitable base.

Restrictions

- The maximum load of 20kN of the luminaire and the accessories depends on the load bearing capacity of the ground and must not be exceeded.
- Luminaires mounted in recessed housing can be driven over by vehicles provided the housing is screwed to a suitable base.

Choosing the mounting location

- Position the luminaire so as to avoid operation in direct sunlight or near other sources of heat. High ambient temperatures can reduce the life and efficiency of the control gear or LED module.
- The luminaire may be mounted in hollow floors such as catwalks or wooden terraces using the mounting kit.
- The luminaire may be mounted with some restrictions in the area of roadways using the recessed housing.



Caution! Risk of accident!

When mounted on traffic routes, please note that the glass poses an increased risk of slipping or skidding when wet.

Safety glass



Warning! Risk of electric shock!

The safety glass functions as a protective shield. The luminaire must only be used complete with its protective shield.  A damaged protective shield must be replaced.

Return the entire luminaire to the factory.

Load on the safety glass

Avoid loads involving hard objects, impact or blows.

Surface temperature of the safety glass

In an ambient temperature of 25°C the safety glass may reach a maximum surface temperature of 52°C.

Electrical installation

For 3-circuit installation: to avoid any damage to the control gear, the neutral conductor must never be connected or disconnected during operation.

Overvoltage protection

ERCO uses electronic control gear with overvoltage protection in accordance with DIN EN 61547. If additional protection from spikes is required, e.g. when switching off inductive loads, separate overvoltage protection units should be installed.

Luminaire with DALI control gear

- All cables, materials and devices used must be suitable for mains voltage, as the DALI signal is not transmitted using safety extra low voltage (SELV).
- For general information on DALI, please go to: www.digitalilluminationinterface.org.

Mounting

1. Mount the accessories in accordance with the accessory instructions.
2. Make the electrical connection via a terminal (to be provided on-site) and junction box (to be provided on-site) (Fig. 1).

Requirements for the connection terminals

- 2-pole screw terminal or screwless terminal (standard),
- 4-pole screw terminal or screwless terminal (DALI)

- 250V min.

- 1A min.

- Prepare conductor ends as specified by the terminal manufacturer.
- Always fit the terminal in a suitable junction box or branch sleeve in compliance with the national regulations.

Wiring connections for DALI

Brown	Phase
Blue	Neutral conductor
Black	DALI
Grey	DALI

3. Place the luminaire in the frame and ensure correct orientation towards the wall (Fig. 2).

Adjusting the luminaire (Fig. 3)

For optimum grazing light wallwashing the luminaire can be adjusted by +/- 10°.

1. To do so, slot the supplied mounting tool at the narrow, right side of the luminaire between the mounting frame and the luminaire.
2. Tilt the LED module into the required position.

Removing the luminaire (Fig. 4)

1. Slot the two supplied mounting tools at the narrow sides of the luminaire between the mounting frame and the luminaire. The nib of each mounting tool must face towards the luminaire.
2. Lift the luminaire out of the frame using both mounting tools at the same time.

Dimming

Depending on the version, the luminaire can be dimmed via suitable dimmers (trailing edge).

Trailing edge dimmers

Follow the manufacturer's installation instructions.

For some products, the luminaire can only be switched on in the upper dimming range. Before installation and connection, check luminaire, control gear and dimmer combination for proper functioning of the dimmer, especially when using universal dimmers.

The use of dimmers which are unsuitable for LED drivers can damage the luminaire, control gear and/or the dimmer. No responsibility is accepted for the use of dimmers that are unsuitable for the luminaire.

Operating instructions

Repairing the connection cable

The connection cable may be trimmed if damaged. To replace the connection cable, return the entire luminaire to the factory.

Please note: The connection cable has capillary protection and is watertight length-wise and may only be replaced by the manufacturer.

Flashing of the LED module

It is normal for the LED module to flicker when switching on and off.

Cleaning

Always clean carefully using a soft cloth and a commercially available, pH-neutral, alcohol-free, non-abrasive cleaning agent.

Cleaning the safety glass

Safety glass can be cleaned with cleaning agents that are also suitable for glass-ceramic cooking hobs.

Disposal

 In accordance with EU Directive

WEEE (Waste Electrical and Electronic Equipment), luminaires must not be disposed of with other household waste. At the end of their life, luminaires must be taken to the appropriate local facility available for the disposal or recycling of electronic products.