

Gecko

Mounting instructions

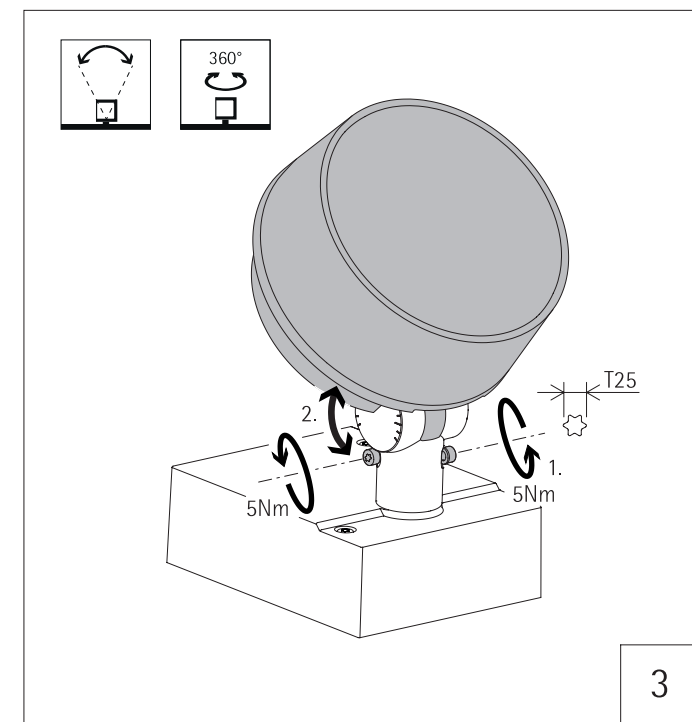

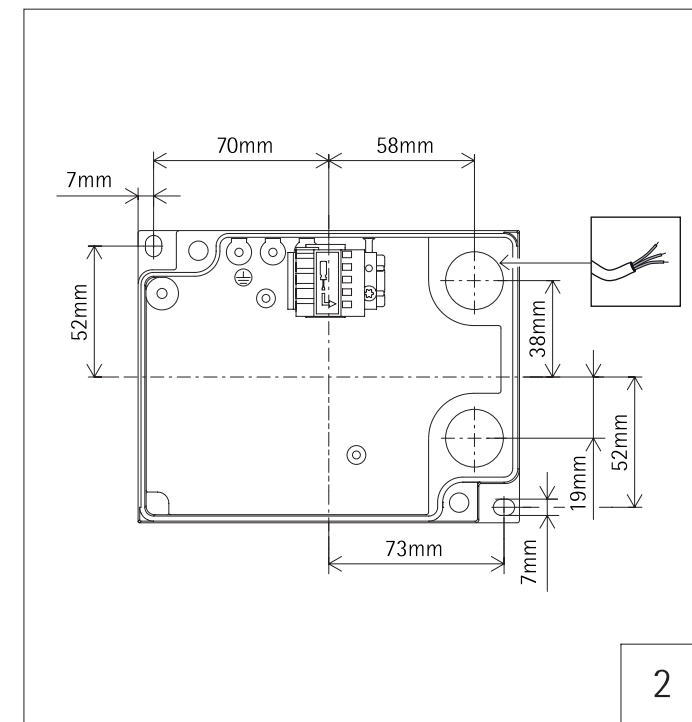
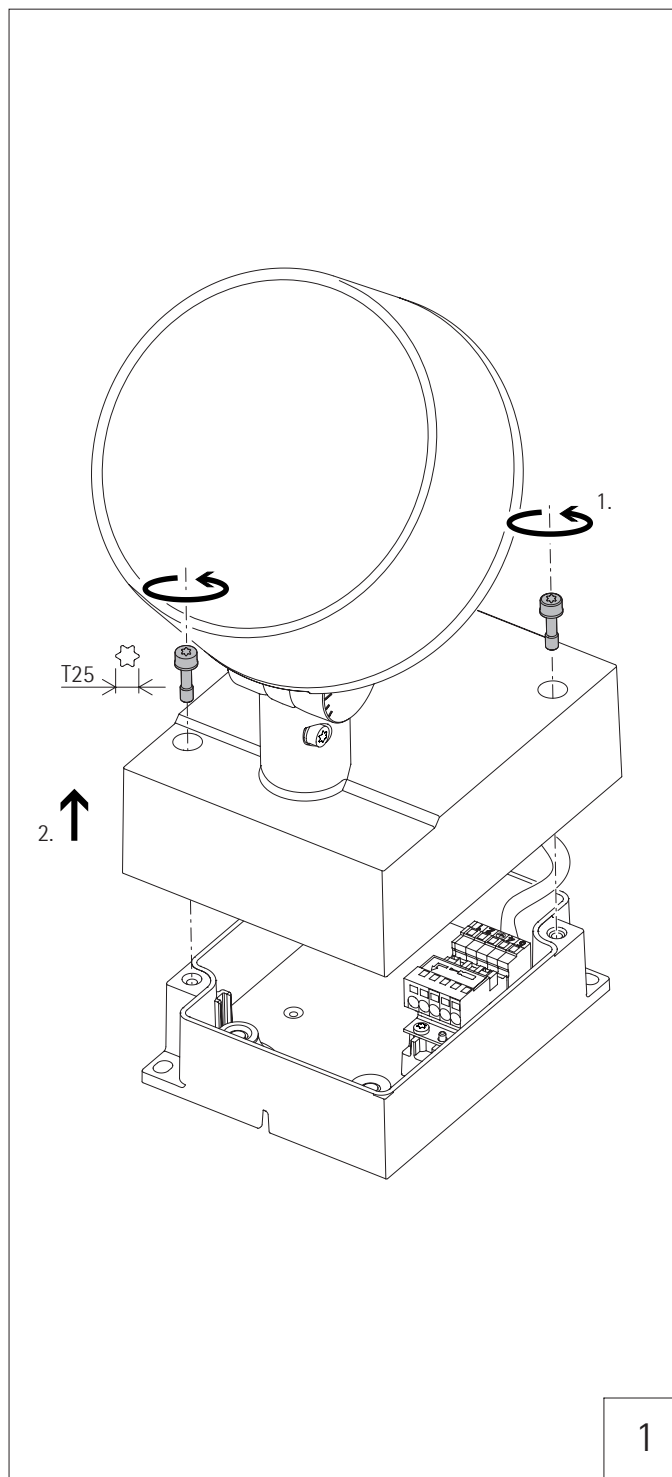
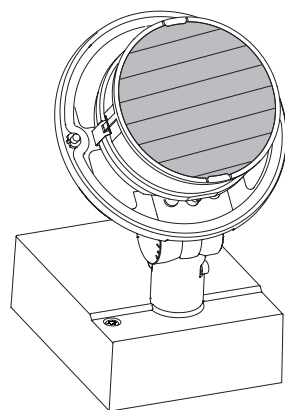
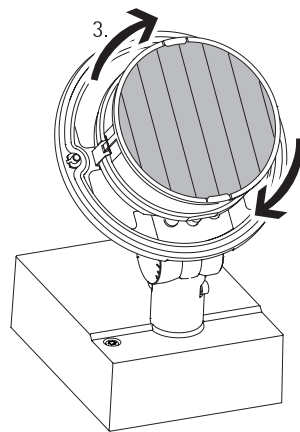
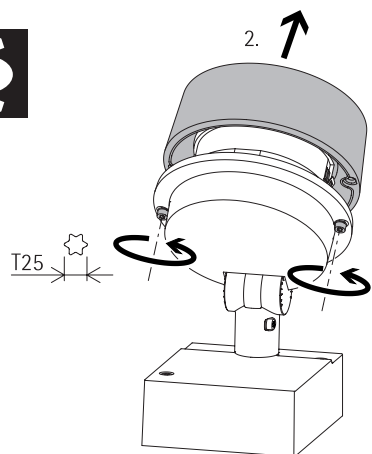

4

English



Read the instructions carefully before installation and commissioning!



Leave the instructions for users/customers for future reference!



Our updated product documentation can be accessed at www.ercos.com/download.

General safety information



Warning!

Risk of electric shock!

Before carrying out maintenance and installation on the luminaire, disconnect from the mains supply and also from any other DALI control wiring, and ensure that all power is switched off.



Warning!

Risk of falling parts!

Before working on the luminaire ensure that no one is standing below.

Attention!

- Do not operate luminaires with damaged or missing protective covers.
- In case of damage or a defective LED module, the entire luminaire must be returned to the factory.
- When installing, always observe the national installation and accident prevention regulations.

Intended use

The luminaire is suitable for both outdoor and indoor use.

Choosing the mounting location

Position the luminaire so as to avoid operation in direct sunlight or near other sources of heat. High ambient temperatures can reduce the life and efficiency of the control gear or LED module.

Electrical installation

For 3-circuit installation: to avoid any damage to the control gear, the neutral conductor must never be connected or disconnected during operation.

Overvoltage protection

ERCO uses electronic control gear with overvoltage protection in accordance with DIN EN 61547. If additional protection from spikes is required, e.g. when switching off inductive loads, separate overvoltage protection units should be installed.

Luminaire with DALI control gear

- All cables, materials and devices used must be suitable for mains voltage, as the DALI signal is not transmitted using safety extra low voltage (SELV).
- For general information on DALI, please go to: www.digitalilluminationinterface.org.

Notes on corrosion protection

Ensure that the powder coating is not damaged during installation or maintenance work. Any damage, which becomes wet, can result in corrosion occurring. In aggressive environments, the installation and maintenance of all parts will require the appropriate protective measures. Chemicals damage the corrosion protection.

Mounting

- You can mount the luminaire on a firm surface (steel structure, brick wall or concrete plinth).

- A ground spike 33973 is available (accessory) for in-ground mounting.

Mounting the luminaire on a ground spike

Note: Follow the accessory instructions.

Mounting the luminaire onto a concrete plinth

Attention! Always select fittings in compliance with the national regulations and standards applicable to the installation site. Ensure suitable corrosion resistance as required for the environment.

1. Open the luminaire (Fig. 1).

2. Remove connector between luminaire and mounting plate. Attach the mounting plate.

Note: The luminaire can be mounted using heavy load rawl bolts M6 in accordance with the manufacturer's instructions.

3. Connect luminaire and reattach connector.

4. Fit luminaire to the mounting plate.

Rotating and tilting the luminaire (Fig. 3)

1. Loosen cylinder head screws.

2. Rotate and tilt luminaire head.

3. Retighten cylinder head screws.

Rotating oval flood (Fig. 4)

1. Loosen cylinder head screws and open luminaire head.

Warning!

Risk of falling parts!

Always hold on to the attachment. When opening the luminaire, the attachment may fall off and injure someone below.

2. Rotate lens into the required position.

3. Close luminaire head in reverse order.

Flashing of the LED module

It is normal for the LED module to flicker when switching on and off.

Cleaning

Always clean carefully using a soft cloth and a commercially available, pH-neutral, alcohol-free, non-abrasive cleaning agent. Take care not to damage the powder-coating.

Cleaning the safety glass

Safety glass can be cleaned with cleaning agents that are also suitable for glass-ceramic cooking hobs.

Disposal



In accordance with EU Directive WEEE (Waste Electrical and Electronic Equipment), luminaires must not be disposed of with other household waste. At the end of their life, luminaires must be taken to the appropriate local facility available for the disposal or recycling of electronic products.